

SAE FULL COUPLINGS

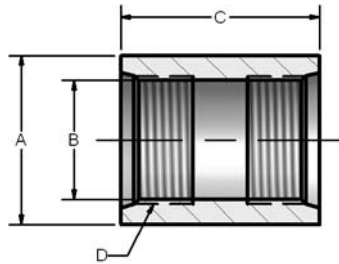

Carbon Steel



SAE TO SAE FULL COUPLING				
PART NO.	A	B	C	D SAE UN-2B
830-6	1.00	.508	1.25	*9/16-18
830-8	1.25	.689	1.63	*3/4-16
830-10	1.38	.806	1.50	*7/8-14
830-12	1.50	.981	2.06	1 1/16-12
830-14	1.63	1.106	2.00	1 3/16-12
830-16	1.75	1.231	2.06	1 5/16-12
830-20	2.25	1.544	2.06	1 5/8-12
830-24	2.75	1.794	2.20	1 7/8-12
830-32	3.25	2.419	2.50	2 1/2-12

- AISI1020 Carbon Steel
- Includes individual thread identification marking
- Additional thread sizes and configurations available

*UNF-2B

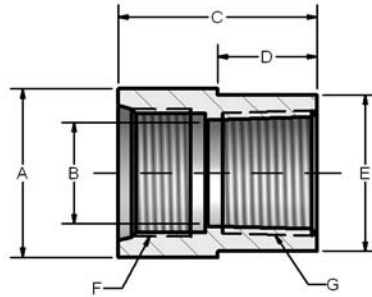

SAE TO NPTF FULL COUPLING							
PART NO.	A	B	C	D	E	F SAE UN-2B	G NPTF
825-4	1.00	.389	1.27	.64	.875	*7/16-20	1/4-18
825-6	1.13	.508	1.50	.75	1.000	*9/16-18	3/8-18
825-8	1.25	.650	1.63	.82	1.125	*3/4-16	1/2-14
825-10-12	1.50	.806	1.75	.88	1.375	*7/8-14	3/4-14
825-12	1.50	.850	2.06	1.03	1.375	1 1/16-12	3/4-14
825-14-16	1.75	1.050	2.15	1.08	1.625	1 3/16-12	1-11.5
825-16	1.75	1.050	2.06	1.03	1.625	1 5/16-12	1-11.5
825-20	2.25	1.420	2.06	1.03	2.125	1 5/8-12	1 1/4-11.5
825-24	2.75	1.650	2.20	1.10	2.500	1 7/8-12	1 1/2-11.5
825-32	3.25	2.125	2.50	1.25	3.000	2 1/2-12	2-11.5

- AISI1020 Carbon Steel
- Includes individual thread identification marking
- Additional thread sizes and configurations available

*UNF-2B

SAE HALF COUPLINGS



Carbon Steel

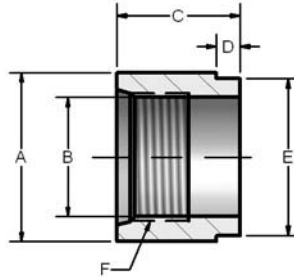

SAE HALF COUPLING						
PART NO.	A	B	C	D	E	F SAE UN-2B
835-4	.88	.389	1.00	.250	.750	*7/16-20
835-6	1.00	.508	1.00	.250	.875	*9/16-18
835-8	1.25	.689	1.06	.250	1.125	*3/4-16
835-10	1.38	.806	1.06	.250	1.250	*7/8-14
835-12	1.50	.981	1.28	.250	1.375	1 1/16-12
835-14	1.63	1.106	1.25	.250	1.500	1 3/16-12
835-16	1.75	1.231	1.28	.250	1.625	1 5/16-12
835-20	2.25	1.544	1.28	.250	2.125	1 5/8-12
835-24	2.75	1.794	1.28	.250	2.500	1 7/8-12
835-32	3.25	2.419	1.50	.250	3.000	2 1/2-12

- AISI1020 Carbon Steel
- Includes individual thread identification marking
- Additional thread sizes and configurations available

*UNF-2B

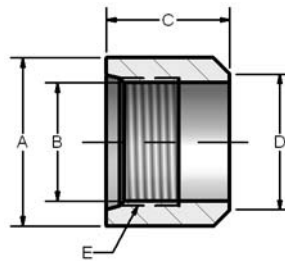

SAE HALF COUPLING BEVEL					
PART NO.	A	B	C	D	E SAE UN-2B
835B-4	.88	.389	1.00	.570	*7/16-20
835B-6	1.00	.508	1.00	.690	*9/16-18
835B-8	1.25	.689	1.06	.870	*3/4-16
835B-10	1.38	.806	1.06	.990	*7/8-14
835B-12	1.50	.981	1.28	1.160	1 1/16-12
835B-14	1.63	1.106	1.25	1.290	1 3/16-12
835B-16	1.75	1.231	1.28	1.410	1 5/16-12
835B-20	2.25	1.544	1.28	1.720	1 5/8-12
835B-24	2.75	1.794	1.28	1.980	1 7/8-12
835B-32	3.25	2.419	1.50	2.600	2 1/2-12

- AISI1020 Carbon Steel
- Includes individual thread identification marking
- Additional thread sizes and configurations available

*UNF-2B

NPTF HALF COUPLINGS



Carbon Steel

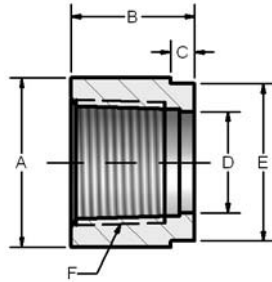

NPTF HALF COUPLING						
PART NO.	A	B	C	D	E	F NPTF
845-4	.88	1.06	.250	.391	.750	1/4-18
845-6	1.00	1.00	.250	.563	.875	3/8-18
845-8	1.25	1.06	.250	.650	1.125	1/2-14
845-12	1.50	1.28	.250	.850	1.375	3/4-14
845-16	1.75	1.28	.250	1.050	1.625	1-11.5
845-20	2.25	1.28	.250	1.420	2.125	1 1/4-11.5
845-24	2.75	1.28	.250	1.560	2.500	1 1/2-11.5
845-32	3.25	1.50	.250	2.125	3.000	2-11.5

- AISI1020 Carbon Steel
- Includes individual thread identification marking
- Additional thread sizes and configurations available

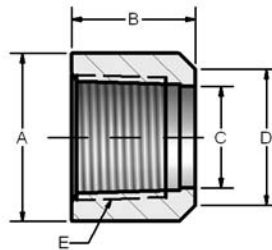

NPTF HALF COUPLING BEVEL					
PART NO.	A	B	C	D	E NPTF
845B-4	.88	1.06	.391	.570	1/4-18
845B-6	1.00	1.00	.563	.690	3/8-18
845B-8	1.25	1.06	.650	.870	1/2-14
845B-12	1.50	1.28	.850	1.160	3/4-14
845B-16	1.75	1.28	1.050	1.410	1-11.5
845B-20	2.25	1.28	1.420	1.720	1 1/4-11.5
845B-24	2.75	1.28	1.560	1.980	1 1/2-11.5
845B-32	3.25	1.50	2.125	2.600	2-11.5

- AISI1020 Carbon Steel
- Includes individual thread identification marking
- Additional thread sizes and configurations available

SOCKET WELD COUPLINGS



Carbon Steel

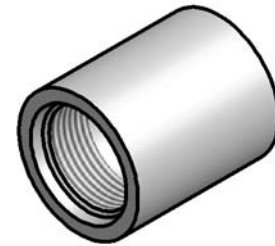
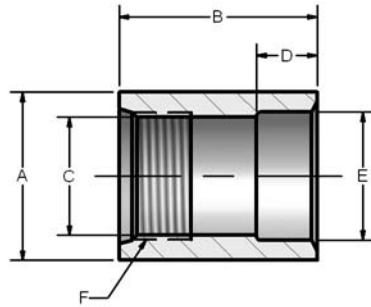

SAE TO SOCKET WELD PIPE COUPLING						
PART NO.	A	B	C	D	E	F SAE UN-2B
820-8	1.25	1.63	.689	.560	.855	*3/4-16
820-12	1.50	2.06	.981	.560	1.062	1 1/16-12
820-16	1.75	2.06	1.231	.630	1.328	1 5/16-12
820-20	2.25	2.06	1.544	.690	1.672	1 5/8-12
820-24	2.75	2.20	1.794	.750	1.922	1 7/8-12
820-32	3.25	2.50	2.419	.875	2.406	2 1/2-12

*UNF-2B

- AISI1020 Carbon Steel
- Includes individual thread identification marking
- Additional thread sizes and configurations available

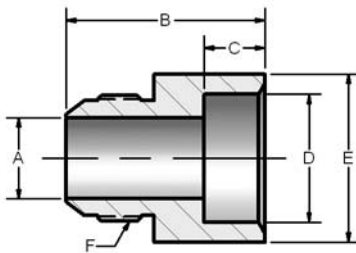

SOCKET WELD PIPE TO MALE JIC COUPLING						
PART NO.	A	B	C	D	E	F SAE UN-2A
840-8	.394	1.63	.560	.855	1.25	*3/4-16
840-12	.611	1.89	.560	1.062	1.50	1 1/16-12
840-16	.844	2.06	.630	1.328	1.75	1 5/16-12
840-20	1.078	2.06	.690	1.672	2.25	1 5/8-12
840-24	1.318	2.20	.750	1.922	2.75	1 7/8-12
840-32	1.781	2.50	.875	2.406	3.25	2 1/2-12

*UNF-2A

- AISI1020 Carbon Steel
- Includes individual thread identification marking
- Additional thread sizes and configurations available

BSPP FULL COUPLINGS



Carbon Steel

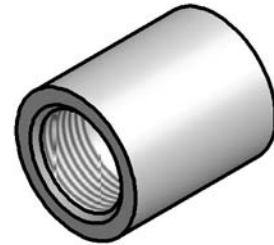
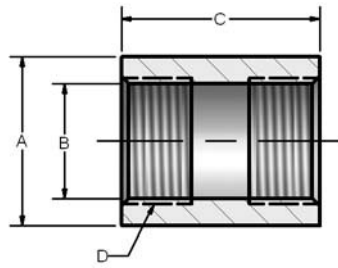

BSPP TO BSPP FULL COUPLING				
PART NO.	A	B	C	D BSPP
850-4	.88	.451	1.25	1/4-19
850-6	1.00	.589	1.25	3/8-19
850-8	1.25	.734	1.63	1/2-14
850-12	1.50	.950	2.06	3/4-14
850-16	1.75	1.193	2.06	1-11
850-20	2.25	1.534	2.06	1 1/4-11
850-24	2.75	1.766	2.20	1 1/2-11
850-32	3.25	2.231	2.50	2-11

- AISI1020 Carbon Steel
- Includes individual thread identification marking
- Additional thread sizes and configurations available

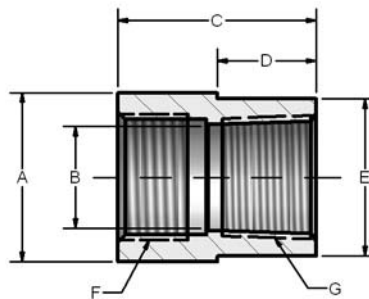

BSPP TO NPTF FULL COUPLING							
PART NO.	A	B	C	D	E	F BSPP	G NPTF
860-4	1.00	.400	1.27	.64	.875	1/4-19	1/4-18
860-6	1.13	.507	1.50	.75	1.000	3/8-19	3/8-18
860-8	1.25	.650	1.63	.82	1.125	1/2-14	1/2-14
860-12	1.50	.850	2.06	1.03	1.375	3/4-14	3/4-14
860-16	1.75	1.050	2.06	1.03	1.625	1-11	1-11.5
860-20	2.25	1.500	2.06	1.03	2.125	1 1/4-11	1 1/4-11.5
860-24	2.75	1.750	2.20	1.10	2.500	1 1/2-11	1 1/2-11.5
860-32	3.25	2.125	2.50	1.25	3.000	2-11	2-11.5

- AISI1020 Carbon Steel
- Includes individual thread identification marking
- Additional thread sizes and configurations available

BSPP HALF COUPLINGS



Carbon Steel

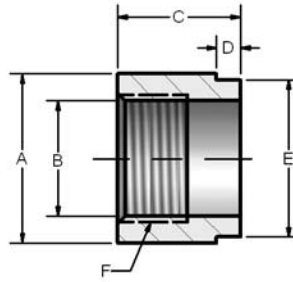

BSPP HALF COUPLING						
PART NO.	A	B	C	D	E	F BSPP
855-4	.88	.451	1.00	.250	.750	1/4-19
855-6	1.00	.589	1.00	.250	.875	3/8-19
855-8	1.25	.734	1.06	.250	1.125	1/2-14
855-12	1.50	.950	1.28	.250	1.375	3/4-14
855-16	1.75	1.193	1.28	.250	1.625	1-11
855-20	2.25	1.534	1.28	.250	2.125	1 1/4-11
855-24	2.75	1.766	1.28	.250	2.500	1 1/2-11
855-32	3.25	2.231	1.50	.250	3.000	2-11

- AISI1020 Carbon Steel
- Includes individual thread identification marking
- Additional thread sizes and configurations available

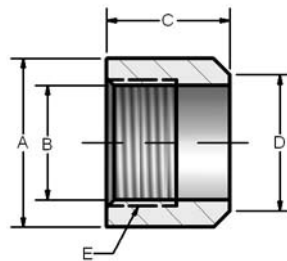

BSPP HALF COUPLING BEVEL					
PART NO.	A	B	C	D	E BSPP
855B-4	.88	.451	1.00	.570	1/4-19
855B-6	1.00	.589	1.00	.690	3/8-19
855B-8	1.25	.734	1.06	.870	1/2-14
855B-12	1.50	.950	1.28	1.160	3/4-14
855B-16	1.75	1.193	1.28	1.410	1-11
855B-20	2.25	1.534	1.28	1.720	1 1/4-11
855B-24	2.75	1.766	1.28	1.980	1 1/2-11
855B-32	3.25	2.231	1.50	2.600	2-11

- AISI1020 Carbon Steel
- Includes individual thread identification marking
- Additional thread sizes and configurations available

SAE FULL COUPLINGS



Stainless Steel

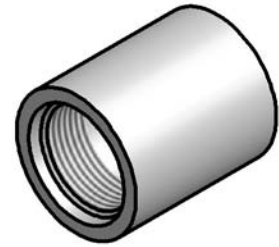
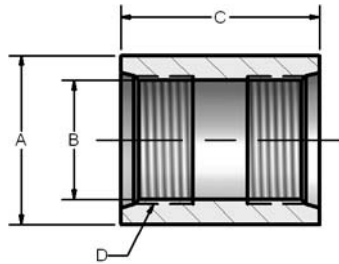

SAE TO SAE FULL COUPLING				
PART NO.	A	B	C	D SAE UN-2B
830-6-SS	1.00	.508	1.25	*9/16-18
830-8-SS	1.25	.689	1.63	*3/4-16
830-10-SS	1.38	.806	1.50	*7/8-14
830-12-SS	1.50	.981	2.06	1 1/16-12
830-14-SS	1.63	1.106	2.00	1 3/16-12
830-16-SS	1.75	1.231	2.06	1 5/16-12
830-20-SS	2.25	1.544	2.06	1 5/8-12
830-24-SS	2.75	1.794	2.20	1 7/8-12
830-32-SS	3.25	2.419	2.50	2 1/2-12

- 316L Stainless Steel
- Includes individual thread identification marking
- Additional thread sizes and configurations available

*UNF-2B

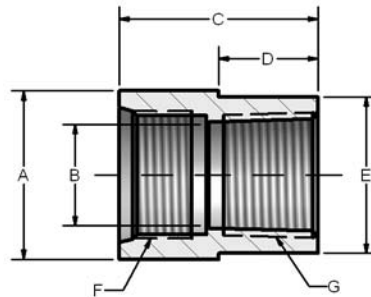

SAE TO NPTF FULL COUPLING							
PART NO.	A	B	C	D	E	F SAE UN-2B	G NPTF
825-4-SS	1.00	.389	1.27	.64	.875	*7/16-20	1/4-18
825-6-SS	1.13	.508	1.50	.75	1.000	*9/16-18	3/8-18
825-8-SS	1.25	.650	1.63	.82	1.125	*3/4-16	1/2-14
825-10-12-SS	1.50	.806	1.75	.88	1.375	*7/8-14	3/4-14
825-12-SS	1.50	.850	2.06	1.03	1.375	1 1/16-12	3/4-14
825-14-16-SS	1.75	1.050	2.15	1.08	1.625	1 3/16-12	1-11.5
825-16-SS	1.75	1.050	2.06	1.03	1.625	1 5/16-12	1-11.5
825-20-SS	2.25	1.420	2.06	1.03	2.125	1 5/8-12	1 1/4-11.5
825-24-SS	2.75	1.650	2.20	1.10	2.500	1 7/8-12	1 1/2-11.5
825-32-SS	3.25	2.125	2.50	1.25	3.000	2 1/2-12	2-11.5

- 316L Stainless Steel
- Includes individual thread identification marking
- Additional thread sizes and configurations available

*UNF-2B

SAE HALF COUPLINGS



Stainless Steel

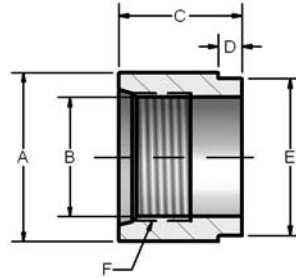

SAE HALF COUPLING						
PART NO.	A	B	C	D	E	F SAE UN-2B
835-4-SS	.88	.389	1.00	.250	.750	*7/16-20
835-6-SS	1.00	.508	1.00	.250	.875	*9/16-18
835-8-SS	1.25	.689	1.06	.250	1.125	*3/4-16
835-10-SS	1.38	.806	1.06	.250	1.250	*7/8-14
835-12-SS	1.50	.981	1.28	.250	1.375	1 1/16-12
835-14-SS	1.63	1.106	1.25	.250	1.500	1 3/16-12
835-16-SS	1.75	1.231	1.28	.250	1.625	1 5/16-12
835-20-SS	2.25	1.544	1.28	.250	2.125	1 5/8-12
835-24-SS	2.75	1.794	1.28	.250	2.500	1 7/8-12
835-32-SS	3.25	2.419	1.50	.250	3.000	2 1/2-12

- 316L Stainless Steel
- Includes individual thread identification marking
- Additional thread sizes and configurations available

*UNF-2B

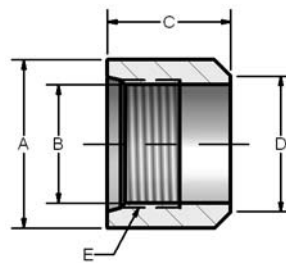

SAE HALF COUPLING BEVEL					
PART NO.	A	B	C	D	E SAE UN-2B
835B-4-SS	.88	.389	1.00	.570	*7/16-20
835B-6-SS	1.00	.508	1.00	.690	*9/16-18
835B-8-SS	1.25	.689	1.06	.870	*3/4-16
835B-10-SS	1.38	.806	1.06	.990	*7/8-14
835B-12-SS	1.50	.981	1.28	1.160	1 1/16-12
835B-14-SS	1.63	1.106	1.25	1.290	1 3/16-12
835B-16-SS	1.75	1.231	1.28	1.410	1 5/16-12
835B-20-SS	2.25	1.544	1.28	1.720	1 5/8-12
835B-24-SS	2.75	1.794	1.28	1.980	1 7/8-12
835B-32-SS	3.25	2.419	1.50	2.600	2 1/2-12

- 316L Stainless Steel
- Includes individual thread identification marking
- Additional thread sizes and configurations available

*UNF-2B

NPTF HALF COUPLINGS



Stainless Steel

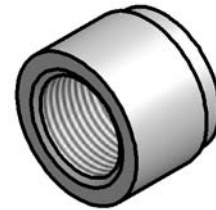
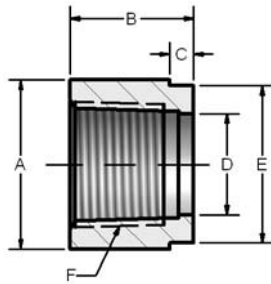

NPTF HALF COUPLING						
PART NO.	A	B	C	D	E	F NPTF
845-4-SS	.88	1.06	.250	.391	.750	1/4-18
845-6-SS	1.00	1.00	.250	.563	.875	3/8-18
845-8-SS	1.25	1.06	.250	.650	1.125	1/2-14
845-12-SS	1.50	1.28	.250	.850	1.375	3/4-14
845-16-SS	1.75	1.28	.250	1.050	1.625	1-11.5
845-20-SS	2.25	1.28	.250	1.420	2.125	1 1/4-11.5
845-24-SS	2.75	1.28	.250	1.560	2.500	1 1/2-11.5
845-32-SS	3.25	1.50	.250	2.125	3.000	2-11.5

-316L Stainless Steel

-Includes individual thread identification marking

-Additional thread sizes and configurations available

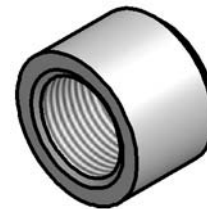
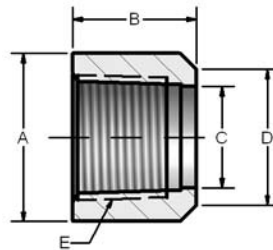

NPTF HALF COUPLING BEVEL					
PART NO.	A	B	C	D	E NPTF
845B-4-SS	.88	1.06	.391	.570	1/4-18
845B-6-SS	1.00	1.00	.563	.690	3/8-18
845B-8-SS	1.25	1.06	.650	.870	1/2-14
845B-12-SS	1.50	1.28	.850	1.160	3/4-14
845B-16-SS	1.75	1.28	1.050	1.410	1-11.5
845B-20-SS	2.25	1.28	1.420	1.720	1 1/4-11.5
845B-24-SS	2.75	1.28	1.560	1.980	1 1/2-11.5
845B-32-SS	3.25	1.50	2.125	2.600	2-11.5

-316L Stainless Steel

-Includes individual thread identification marking

-Additional thread sizes and configurations available

SOCKET WELD COUPLINGS



Stainless Steel

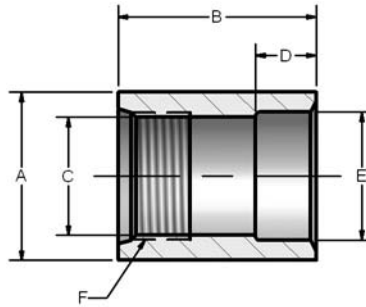

SAE TO SOCKET WELD PIPE COUPLING						
PART NO.	A	B	C	D	E	F SAE UN-2B
820-8-SS	1.25	1.63	.689	.560	.855	*3/4-16
820-12-SS	1.50	2.06	.981	.560	1.062	1 1/16-12
820-16-SS	1.75	2.06	1.231	.630	1.328	1 5/16-12
820-20-SS	2.25	2.06	1.544	.690	1.672	1 5/8-12
820-24-SS	2.75	2.20	1.794	.750	1.922	1 7/8-12
820-32-SS	3.25	2.50	2.419	.875	2.406	2 1/2-12

*UNF-2B

- 316L Stainless Steel
- Includes individual thread identification marking
- Additional thread sizes and configurations available

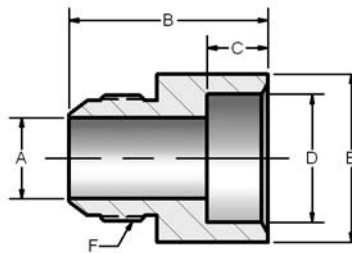

SOCKET WELD PIPE TO MALE JIC COUPLING						
PART NO.	A	B	C	D	E	F SAE UN-2A
840-8-SS	.394	1.63	.560	.855	1.25	*3/4-16
840-12-SS	.611	1.89	.560	1.062	1.50	1 1/16-12
840-16-SS	.844	2.06	.630	1.328	1.75	1 5/16-12
840-20-SS	1.078	2.06	.690	1.672	2.25	1 5/8-12
840-24-SS	1.318	2.20	.750	1.922	2.75	1 7/8-12
840-32-SS	1.781	2.50	.875	2.406	3.25	2 1/2-12

*UNF-2A

- 316L Stainless Steel
- Includes individual thread identification marking
- Additional thread sizes and configurations available

BSPP FULL COUPLINGS



Stainless Steel

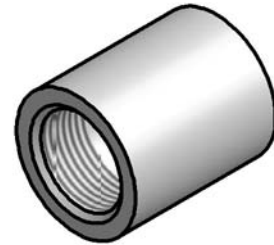
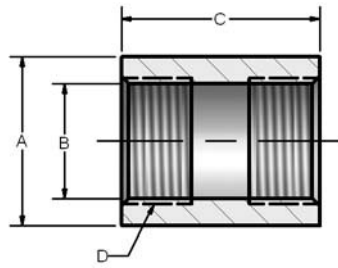

BSPP TO BSPP FULL COUPLING				
PART NO.	A	B	C	D BSPP
850-4-SS	.88	.451	1.25	1/4-19
850-6-SS	1.00	.589	1.25	3/8-19
850-8-SS	1.25	.734	1.63	1/2-14
850-12-SS	1.50	.950	2.06	3/4-14
850-16-SS	1.75	1.193	2.06	1-11
850-20-SS	2.25	1.534	2.06	1 1/4-11
850-24-SS	2.75	1.766	2.20	1 1/2-11
850-32-SS	3.25	2.231	2.50	2-11

- 316L Stainless Steel
- Includes individual thread identification marking
- Additional thread sizes and configurations available

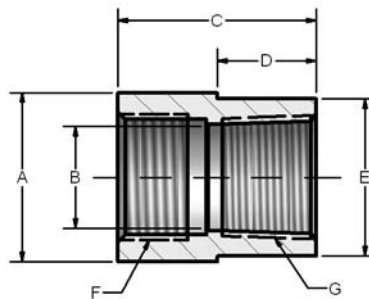

BSPP TO NPTF FULL COUPLING							
PART NO.	A	B	C	D	E	F BSPP	G NPTF
860-4-SS	1.00	.400	1.27	.64	.875	1/4-19	1/4-18
860-6-SS	1.13	.507	1.50	.75	1.000	3/8-19	3/8-18
860-8-SS	1.25	.650	1.63	.82	1.125	1/2-14	1/2-14
860-12-SS	1.50	.850	2.06	1.03	1.375	3/4-14	3/4-14
860-16-SS	1.75	1.050	2.06	1.03	1.625	1-11	1-11.5
860-20-SS	2.25	1.500	2.06	1.03	2.125	1 1/4-11	1 1/4-11.5
860-24-SS	2.75	1.750	2.20	1.10	2.500	1 1/2-11	1 1/2-11.5
860-32-SS	3.25	2.125	2.50	1.25	3.000	2-11	2-11.5

- 316L Stainless Steel
- Includes individual thread identification marking
- Additional thread sizes and configurations available

BSPP HALF COUPLINGS



Stainless Steel

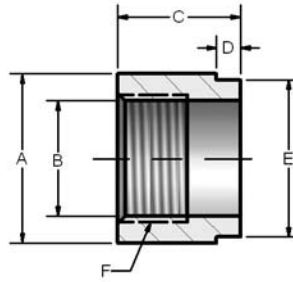
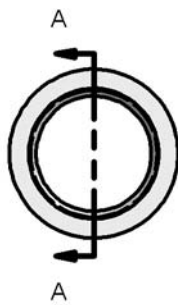

BSPP HALF COUPLING						
PART NO.	A	B	C	D	E	F BSPP
855-4-SS	.88	.451	1.00	.250	.750	1/4-19
855-6-SS	1.00	.589	1.00	.250	.875	3/8-19
855-8-SS	1.25	.734	1.06	.250	1.125	1/2-14
855-12-SS	1.50	.950	1.28	.250	1.375	3/4-14
855-16-SS	1.75	1.193	1.28	.250	1.625	1-11
855-20-SS	2.25	1.534	1.28	.250	2.125	1 1/4-11
855-24-SS	2.75	1.766	1.28	.250	2.500	1 1/2-11
855-32-SS	3.25	2.231	1.50	.250	3.000	2-11

- 316L Stainless Steel
- Includes individual thread identification marking
- Additional thread sizes and configurations available

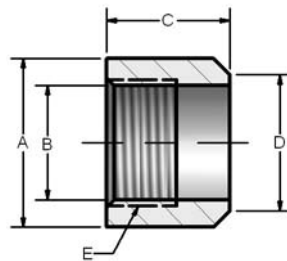
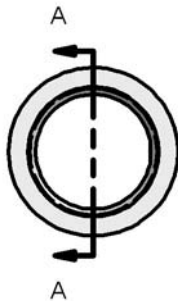

BSPP HALF COUPLING BEVEL					
PART NO.	A	B	C	D	E BSPP
855B-4-SS	.88	.451	1.00	.570	1/4-19
855B-6-SS	1.00	.589	1.00	.690	3/8-19
855B-8-SS	1.25	.734	1.06	.870	1/2-14
855B-12-SS	1.50	.950	1.28	1.160	3/4-14
855B-16-SS	1.75	1.193	1.28	1.410	1-11
855B-20-SS	2.25	1.534	1.28	1.720	1 1/4-11
855B-24-SS	2.75	1.766	1.28	1.980	1 1/2-11
855B-32-SS	3.25	2.231	1.50	2.600	2-11

- 316L Stainless Steel
- Includes individual thread identification marking
- Additional thread sizes and configurations available